

Sprint

USER GUIDE

An advanced booster seat with cup holder and adjustable arm rests
Suitable for use from 15kg to 36kg (approx 4 to 11 years)



Can be fitted in front* and back seats of most cars using the adult lap and diagonal seat-belt.



***WARNING: DO NOT use on passenger seats fitted with a front airbag unless your vehicle manufacturer confirms it is safe.**

Britax

THE MOST TESTED CAR SEAT ON THE ROAD

Thank you for choosing Britax

It is important that you read this User Guide **BEFORE** trying to install your child car seat (surveys have revealed that 7 out of 10 car seats are not installed correctly or being used properly - Source: RAC).

Contents

Vital information - Read now	page 2
Frequently asked questions	page 2
Crucial parts of your child car seat	page 3
Preparing to install the Britax Sprint in the car	
Adjusting the arm rests	page 4
Using the Britax Sprint – From 15kg to 36kg (approx 4- 11 years)	
Installing the Britax Sprint in the car	page 5
Correct buckle position	page 7
Releasing your child from the Britax Sprint	page 7
Using the pull-out tray and cup holder	page 8
Looking after your Britax Sprint	
Removing the cover	page 9
Cleaning & refitting the cover	page 10
Cleaning the seat shell	page 10
Important information - Read before your first journey	page 11
Final checklist	page 12
If in doubt	page 12

Vital information - Read now

DO NOT use the Britax Sprint on a passenger seat fitted with a front airbag unless your vehicle manufacturer confirms it is safe.

DO NOT use the Britax Sprint on side facing vehicle seats.

DO NOT attempt to dismantle, modify or add to any part of the Britax Sprint or change the way your car seat-belts are made or used. The official approval is no longer valid if modifications are made. No modifications may be made to the Britax Sprint other than by the manufacturer.

DO cover the Britax Sprint if your car is left in direct sunlight. Metal and plastic fittings can become hot to touch in sunny weather and the cover may become faded.

DO follow these user guide instructions in the order shown and get to know your Britax Sprint before installing it in your car.

DO keep this user guide safe for future reference. There is a storage facility for it in the base of the Britax Sprint.

DO always keep the Britax Sprint secure. Even if it is not being used by your child.

DO make sure that the Britax Sprint does not become trapped by a folding passenger seat or in the door of your car.

DO make sure when using positions with side airbags, that your child does not lean into the area immediately around the airbag (consult your vehicle manufacturer for details).

Frequently asked questions

Britax, whilst taking into account child car seat contact with vehicle seats throughout the development of new products, cannot accept responsibility for damage occurring to vehicle seats.

Does the Britax Sprint fit all cars?

All makes, models and years of car differ from one another and it is not guaranteed that this restraint will fit your car. For advice as to the suitability of this restraint for your car please call our Customer Service Helpline on 01264 386034.

Can I put my child in the Britax Sprint before they reach 15kg in weight?

No, the weight range corresponds with the European Standard applying to child car seats and Britax Sprint has been tested and approved from 15kg.

Can I install the Britax Sprint using a lap-belt?

*No, the Britax Sprint **MUST** only be used with a lap and diagonal seat-belt.*

Can I buy a spare cover in the same fabric I currently have?

*Spare covers are available in **SELECTED** fabrics only. To find out which fabrics you can choose from please contact our Customer Service Helpline on 01264 386034.*

No child seat is escape proof

Belt restraint systems cannot be designed to be completely “child proof” and yet comply with the legal requirements of European Standard ECE R44. The seat-belt must be fastened, the shoulder belt guide must be adjusted correctly at all times and children should be encouraged to remain within the belt restraint system.

Second-hand car seats

The Hampshire Trading Standards Authority and Britax advise that child car seats should not be bought or sold second-hand. Many seats sold through local advertising and car-boot sales have been found to be dangerous. Please dispose of your child seat safely.

Crucial parts of your child car seat

You need to know these before installing the Britax Sprint in your car.

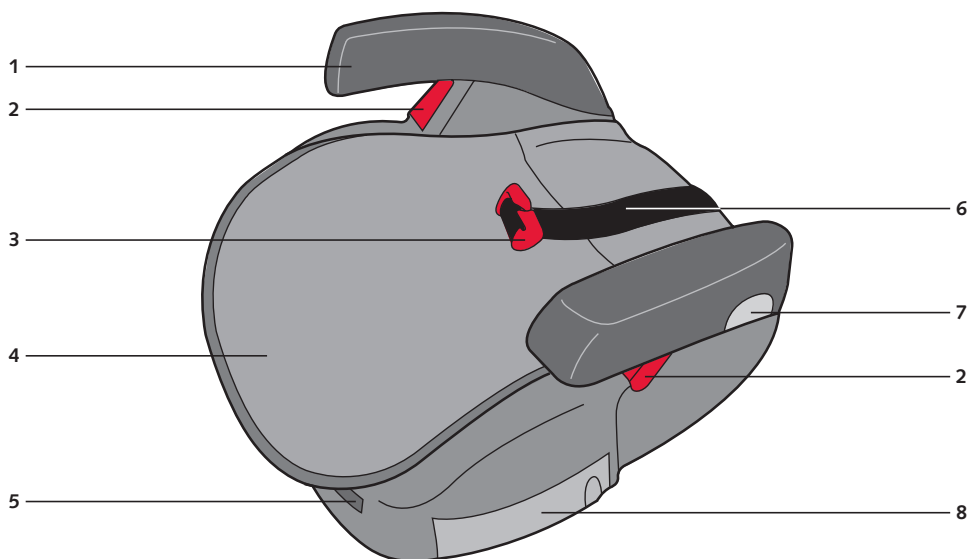

- | | |
|------------------------------|---|
| 1. Arm rests | 5. User Guide storage slot |
| 2. Lap belt guides (red) | 6. Shoulder strap |
| 3. Shoulder belt guide (red) | 7. Armrest with adjuster button |
| 4. Cover | 8. Pull-out tray (cup holder on other side) |

Types of seat-belt

 **IMPORTANT** - The Britax Sprint **MUST** only be used with a lap and diagonal seat-belt (approved to UN/ECE Regulation no. 16 or other equivalent standards).

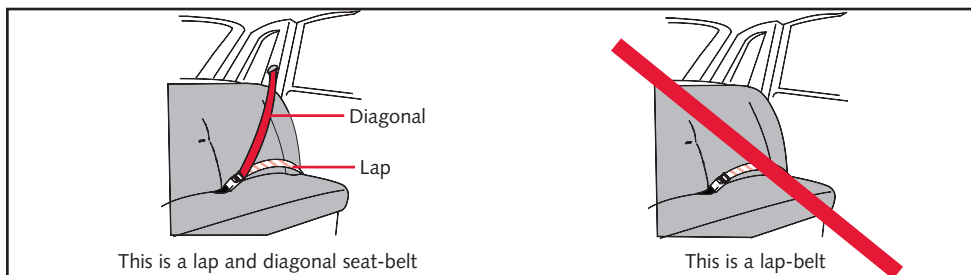

Preparing to install the Britax Sprint in the car

Adjusting the arm rests

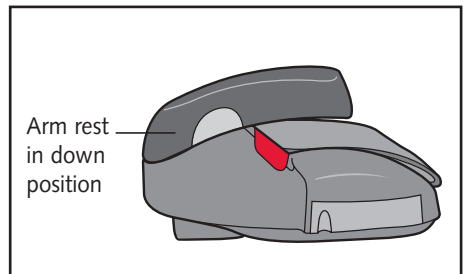
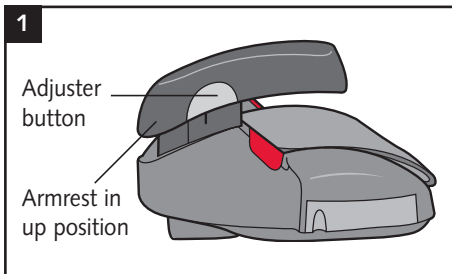

With the seat supported, press and hold the adjuster button on the side of the armrest. Move the armrest up or down according to preference. With the armrest in the desired position, let go of the adjuster button and ensure it is locked into place.

Stage 1 - Using the Britax Sprint - from 15kg to 36kg (approx 4-11 years)

Installing the Britax Sprint in the car

⚠ IMPORTANT - You **MUST NOT** use the Britax Sprint for a child weighing more than 36kg.

⚠ IMPORTANT - The Britax Sprint **MUST** only be installed using a lap and diagonal seat-belt.

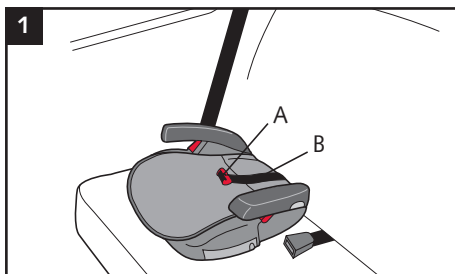

Place the booster seat in your car ensuring it is pushed firmly into the seat. (A) is the red seat-belt guide and (B) is the shoulder strap.

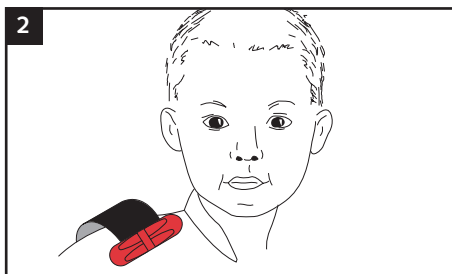

Sit your child on the seat. Make sure that the shoulder strap is long enough for the red seat-belt guide to lie over your child's shoulder. If necessary use the methods shown below to adjust the length.

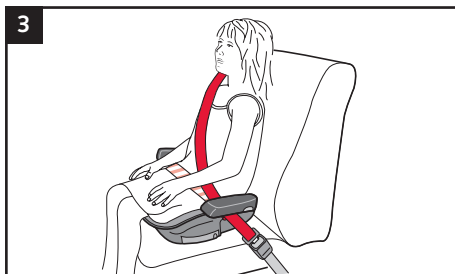
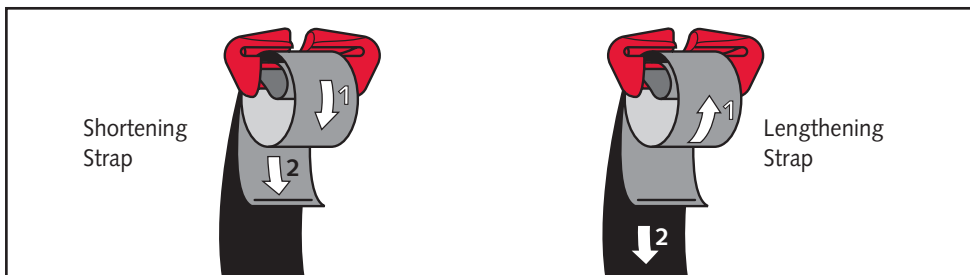

Fasten the seat-belt across your child. The lap section of the seat-belt should sit as forward and as low as possible over your child's thighs, resting on the red lap belt guides on each side of the booster section.

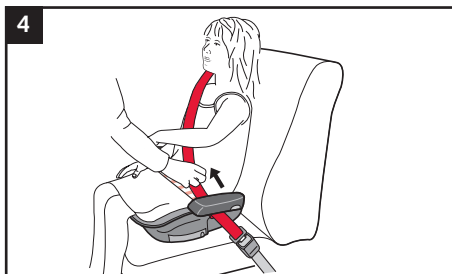

Adjust the seat-belt to suit your child's body. Remove as much slack as possible and make sure that the seat-belt is not twisted.

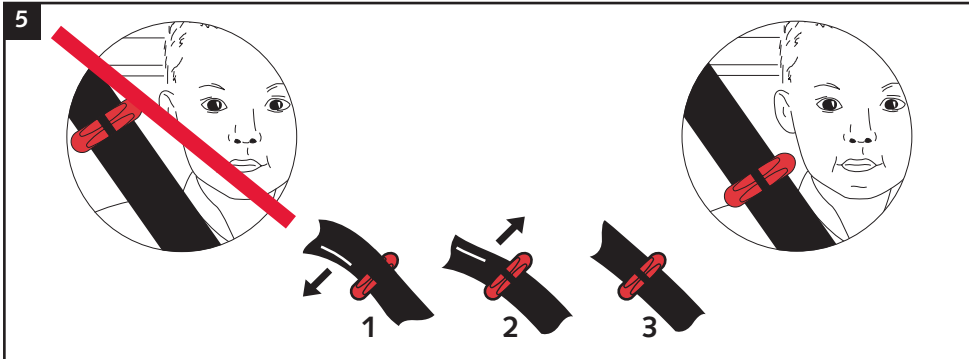

Attach the red shoulder belt guide to the diagonal section of the car seat-belt and adjust the shoulder strap so that the guide sits just above your child's shoulder as shown above. This ensures that the seat-belt sits correctly over your child's shoulder and not across the neck. Remove as much slack as possible and make sure the belt is not twisted.

Your child should now be secure.

Re-threading the shoulder belt guide

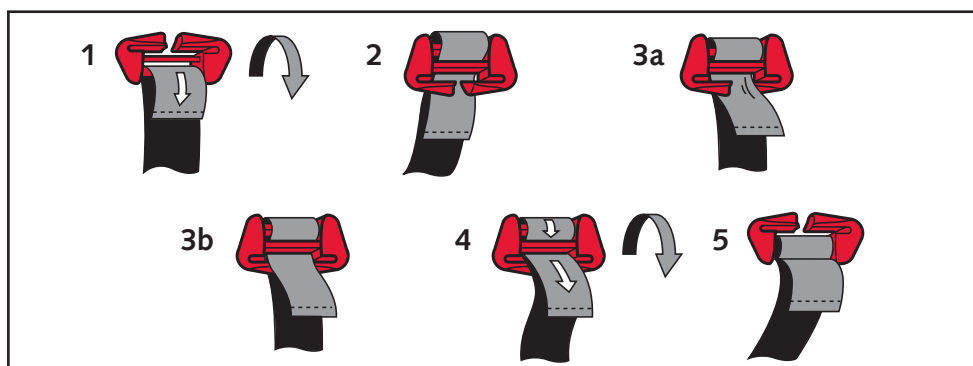

Should the shoulder belt guide come undone from the strap, use the following method to re-thread it.

1. With the booster seat facing away from you, thread the end of the strap through the bottom of the guide.
2. Roll the guide towards you.
- 3a. Feed the short end of the strap through the gap in the guide...
- 3b. ...and then do the same for the longer length of strap.
4. When both pieces of strap are through the gap the guide is properly attached.
5. Roll the guide away from you. Your shoulder belt guide should now look like this.

Correct buckle position

Once you have installed the Britax Sprint it is important that you check the position of the seat-belt buckle to ensure a secure installation.

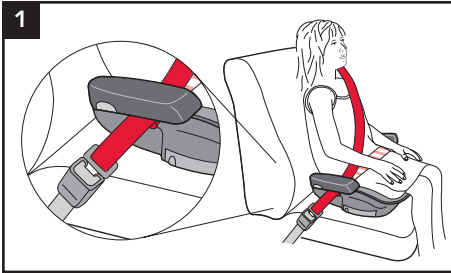

If the seat-belt buckle looks like this then the seat-belt buckle position is O.K.

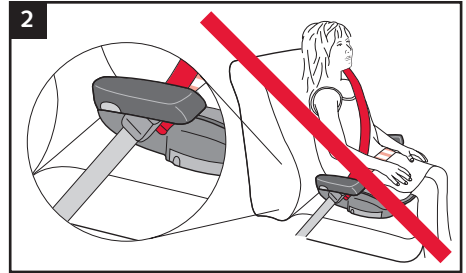

If the seat-belt buckle looks like this, where the buckle is being pulled around the shell into the red lower belt guide, try another seating position in the car.

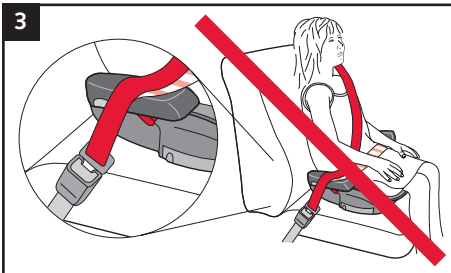

If the seat belt does not lie within the red lower belt guides then the seat is not properly installed.

If you are in any doubt please contact our Customer Service Helpline on 01264 386034.

Releasing your child from the Britax Sprint

To release your child simply undo the seat-belt.



IMPORTANT - Do not leave your child seat loose. Always fasten the seat-belt across the Britax Sprint when it is not being used by your child to prevent the seat being hurled forward in the event of an accident.

Using the pull-out tray and cup holder

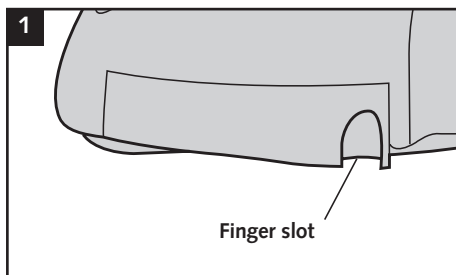

To open the pull-out tray and cup holder, pull firmly using the finger slot.

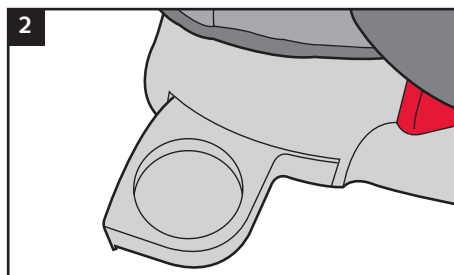

The tray will hinge forward and click into place.

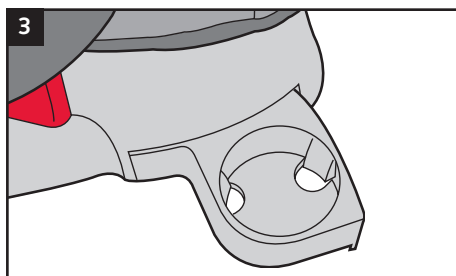

The cup holder is on the opposite side of the seat to the tray.

 **IMPORTANT - DO NOT** place pencils or other sharp pointed objects into the pull-out tray or cup holder.

 **IMPORTANT** - To avoid burns or scalds **NEVER** put hot liquids into the pull-out tray or cup holder.

 **Handy tip** - Small items held in the tray may fall into the casing of the Britax Sprint from time to time. In this case simply tip the seat forward to allow them to fall out through the user guide slot.

In some vehicles seat shape and interior design may prevent use of the pull out tray and cup holder.

Looking after the Britax Sprint

Removing the cover

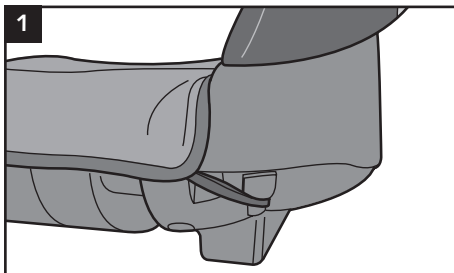

Unhook the elastics which hold the cover in place. The red spots on diagram A show their location.

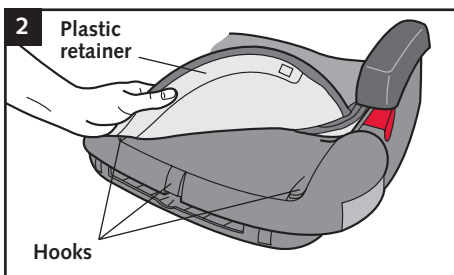
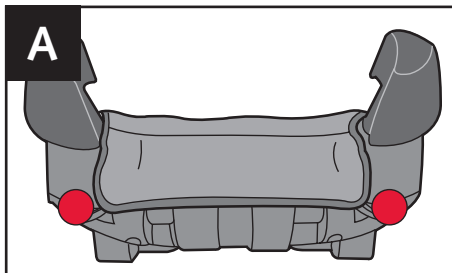

Unhook the plastic retainer from the hooks at the front of the seat.

Cleaning the Cover

Please read the labels on the cover for washing instructions.

DO NOT tumble dry the cover - Short spin and drip dry only.

Refitting the Cover

Refit the cover by reversing the instructions in the section 'Removing the Cover'.



Handy tip - When refitting the cover, ensure that the hooks go through the square holes in the plastic retainer at the front of the seat.

Replacement Cover

The Britax Sprint and its cover have been carefully designed, manufactured and tested to high safety standards.



IMPORTANT - The cover is a safety feature. **NEVER** use the Britax Sprint without it. Don't put your child's safety at risk by using other makes of replacement cover, they could stop the Britax Sprint from protecting your child as well as it should.

A replacement cover is available from your Britax stockist or contact Britax Customer Service Department on 01264 386034.

Cleaning the seat shell

Sponge clean **ONLY** using hand soap and warm water.

DO NOT take apart, or attempt to take apart, any part of the seat when cleaning. It is unnecessary and dangerous to do so.

DO NOT use solvents, detergents or washing-up liquid as these may weaken the seat.

DO NOT lubricate or oil any part of the seat.

Important Information - Read before your first journey

DO store the Britax Sprint in a safe place when it is not being used. Avoid placing heavy objects on top of it and do not store near direct heat sources, e.g. radiators.

DO make sure the vehicle seat belt is only used in the seat-belt guides described in this user guide.

DO NOT use your Britax Sprint in the home. It has not been designed for home use and should only be used in your car.

DO NOT use anything, such as a cushion or coat, to raise your Britax Sprint off the passenger seat. In an accident the Britax Sprint and car seat-belts would not be able to protect your child as well as they should.

DO NOT attempt to dismantle, modify or add to any part of the Britax Sprint or change the way it is made or used.

DO NOT carry unrestrained passengers or loose objects, such as luggage or books, in the back of your car. They must be secured because, if you have to stop your car suddenly, they will keep moving and can then cause serious injuries. Large and heavy loose objects are a particular risk.

DO NOT leave folding passenger seats unlatched. If you have to stop your car suddenly a loose seat back could injure your child.

DO NOT leave children alone in your car, even for a short time.

DO NOT allow children to play with or adjust the Britax Sprint.

After an accident

After an accident, the Britax Sprint and your car seat-belts should be replaced. Although they may look undamaged, if you were to have another accident the Britax Sprint and your car seat-belts may not be able to protect your child as well as they should.

Guarantee

All Britax products are carefully designed, manufactured and tested. However, should this product prove faulty within 12 months of purchase due to a materials or manufacturing fault please return it to the original place of purchase. We will then, at our discretion, either repair it free of charge or replace it with the same or a similar product.

For guarantee purposes proof of purchase will be required. We recommend that you retain your receipt. It should be kept in a safe place.

Britax does not accept liability for damage arising from abuse, misuse or negligence. This guarantee is not transferable and therefore does not apply to second-hand products. Your statutory rights are not affected by this guarantee.

Final Checklist

However safe a child seat is, however well built it is, your child's safety depends on you. Read through this final checklist every time you use the Britax Sprint in your vehicle.

1. Have you installed the Britax Sprint properly?
See page 5, Installing the Britax Sprint in the car.
2. Have you checked the seat-belt buckle position?
See page 7, Correct buckle position.

If in doubt

If in doubt contact our Customer Service Helpline. It would help if you have the following information to hand before making any enquiry:

Make and model of vehicle

.....

.....

Year of vehicle

The position of the child seat in your vehicle

.....

.....

Age and weight of your child

.....

Customer Service Department
Britax Excelsior Limited
1 Churchill Way West
Andover, Hampshire, SP10 3UW
United Kingdom

Customer Service Helpline
Telephone: 01264 386034
email: helpline@britax.co.uk
www.britax.co.uk

Point of Sale Information**NOTICE**

1. This is a "Universal" child restraint. It is approved to Regulation No. 44.03 series of amendments, for general use in vehicles and it will fit most, but not all, car seats.
2. A correct fit is likely if the vehicle manufacturer has declared in the vehicle handbook that the vehicle is capable of accepting a "Universal" child restraint for this age group.
3. This child restraint has been classified as "Universal" under more stringent conditions than those which applied to earlier designs which do not carry this notice.
4. If in doubt, consult either the child restraint manufacturer or the retailer.
5. Only suitable if the approved vehicles are fitted with 3 point/static/ with retractor safety-belts, approved to UN/ECE Regulation No. 16 or other equivalent standards.



FM22321
QS9000

Britax Excelsior Limited

1 Churchill Way West
Andover
Hampshire SP10 3UW
United Kingdom

A Britax Childcare company

Customer Service Helpline:
01264 386034
Sales: 01264 386027
Switchboard: 01264 333343
Fax: 01264 334146

www.britax.co.uk

